

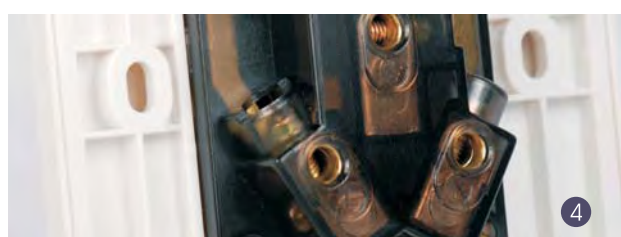

HB274-N
16A 4 Gang 1 Way Switch

- 1 Top quality polycarbonate construction with modern profile
- 2 Easily replaceable switch plates to renew your modern décor anytime
- 3 Extra large wiring terminals for easy connections
- 4 Double earth terminals for safer sockets

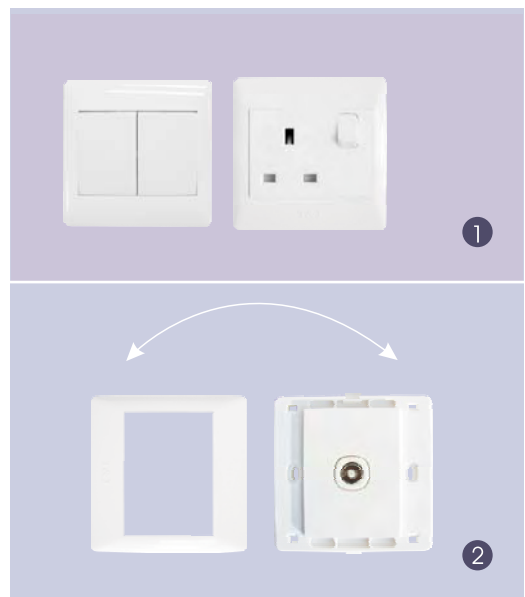

HB802-SB
4 Gang Microphone Socket



HB801-4TU
1 Gang 4 Core RJ11 American Telephone Socket



HB813S
13A 1 Gang Switched Socket



Switches

	Product	Model No.	Description	Pack (carton/box)
1		HB271-N HB271-2-N HB271L-DP	16A 1 Gang 1 Way Switch 16A 1 Gang 2 Way Switch 20A 1 Gang DP Switch with neon	100/10 100/10 100/10
2		HB272-N HB272-2-N	16A 2 Gang 1 Way Switch 16A 2 Gang 2 Way Switch	100/10 100/10
3		HB273-N HB273-2-N	16A 3 Gang 1 Way Switch 16A 3 Gang 2 Way Switch	100/10 100/10
4		HB274-N HB274-2-N	16A 4 Gang 1 Way Switch 16A 4 Gang 2 Way Switch	100/10 100/10
5		HB275-N HB275-2-N	16A 5 Gang 1 Way Switch 16A 5 Gang 2 Way Switch	50/5 50/5
6		HB245 HB245L	45A 1 Gang DP Switch 45A 1 Gang DP Switch with neon	90/9 90/9

Retractive Switches

	Product	Model No.	Description	Pack (carton/box)
1		HB271-B-N	16A 1 Gang Bell Switch	100/10
2		HB261-N HB261-2-N	16A 1 Gang 1 Way Retractive Switch 16A 1 Gang 2 Way Retractive Switch	100/10 100/10
3		HB262-N HB262-2-N	16A 2 Gang 1 Way Retractive Switch 16A 2 Gang 2 Way Retractive Switch	100/10 100/10
4		HB263-N HB263-2-N	16A 3 Gang 1 Way Retractive Switch 16A 3 Gang 2 Way Retractive Switch	100/10 100/10



Retractive Switches

	Product	Model No.	Description	Pack (carton/box)
5		HB264-N HB264-2-N	16A 4 Gang 1 Way Retractive Switch 16A 4 Gang 2 Way Retractive Switch	100/10 100/10
6		HB265-N HB265-2-N	16A 5 Gang 1 Way Retractive Switch 16A 5 Gang 2 Way Retractive Switch	50/5 50/5

Dimmers

	Product	Model No.	Description	Pack (carton/box)
1		HB211-M2 HB211-1KM2	630W 230V 1 Gang Dimmer with off position 1000W 230V 1 Gang Dimmer with off position	50/5 50/5

BS Sockets

	Product	Model No.	Description	Pack (carton/box)
1		HB813	13A 1 Gang Socket	100/10
2		HB813S	13A 1 Gang Switched Socket	100/10
3		HB813SD	13A 2 Gang Switched Socket	50/5
4		HB815S	15 A 1 Gang Switched Socket	100/10
5		HB2548L	45A Cooker Control Unit & 13A Switched Socket with neon	50/5



Universal Sockets

Product	Model No.	Description	Pack (carton/box)
	HB829	10A 1 Gang 2 Pin & 2 Pin + Earth Universal Socket	100/10
	HB810U2	10A 2 Gang 2 Pin Socket	100/10

Audio and Video Products

Product	Model No.	Description	Pack (carton/box)
	HB2-V	1 Gang Volume Switch	50/5
	HB2-SV	Channel Selection Switch & Volume Switch	50/5
	HB801-SB	1 Gang Speaker Socket (Banana jack)	50/5
	HB802-SB	2 Gang Speaker Socket (Banana jack)	50/5
	HB801-MIC	1 Gang Microphone Socket	50/5
	HB802-MIC	2 Gang Microphone Socket	50/5
	HB804-MIC	4 Gang Microphone Socket	50/5









Telecommunication Products

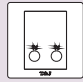
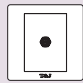

Product	Model No.	Description	Pack (carton/box)
	HB801-4TU	1 Gang Rj11 Telephone Socket (4 Pin)	100/10
	HB801-6TU	1 Gang Rj11 Telephone Socket (6 Pin)	100/10
	HB802-4TU	1 Gang Rj11 Telephone Socket (4 Pin, 1 input 2 output)	100/10
	HB801-TM	1 Gang BT Master Telephone Socket	100/10
	HB801TV	1 Gang TV Socket	100/10
	HB802TV	1 Gang TV Socket (1 input 2 output)	100/10
	HB801TV-4TU HB801TV-6TU	1 Gang TV Socket & 1 Gang Rj11	100/10 100/10
	HB801TVO	1 Gang TV Socket with 1 branch output & Surge Protection	100/10
	HB803TVO	1 Gang TV Socket with 3 branch output & Surge Protection	100/10
	HB803TV	2 Gang TV Socket (2 input 2 output)	100/10
	HB802TV-FM	1 Gang TV & FM Socket	100/10



Telecommunication Products

Product	Model No.	Description	Pack (carton/box)
	HB802ETV	2 Gang SAT. TV Socket	100/10
	HB801ETV	1 Gang SAT. TV Socket	100/10
	HB801-PC	1 Gang Rj45 Cat. 5e Data Socket	50/5
	HB802-PC	2 Gang Rj45 Cat. 5e Data Socket	50/5
	HB801PC-4TU	1 Gang Rj45 Cat.5e Data Socket & Rj11 Telephone Socket (4 Pin)	50/5
	HB801PC-6TU	1 Gang Rj45 Cat.5e Data Socket & Rj12 Telephone Socket (6 Pin)	50/5
	HB801TV-PC	1 Gang TV Socket & 1 Gang Rj45 Cat.5e Data Socket	50/5

Hotel Products

Product	Model No.	Description	Pack (carton/box)
	HB2C-MB	10A Bell Switch with “ Make Up Room ” indicator	100/10
	HB2C-DB	10A Bell Switch with “ Do Not Disturb ” indicator	100/10

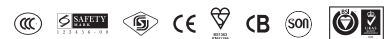

Hotel Products

Product	Model No.	Description	Pack (carton/box)
	HB2C-DM	“ Do Not Disturb ” & “ Make Up Room ” indicator	100/10
	HB2C-DMB	10A Bell Switch with “ Do Not Disturb ” & “ Make Up Room ” indicator	100/10
	HB2C-DMPB	10A Bell Switch with “ Do Not Disturb ” & “ Make Up Room ” & “ Please Wait ” indicator	100/10
	HB3-KT	16A 127V 1 Gang Key Card Switch with time delay	50/5
	HB2-KT	16A 230V 1 Gang Key Card Switch with time delay	50/5
	HB2-KT3	32A 230V 1 Gang Key Card Switch with time delay	50/5
	HB2-KTA	16A 230V 1 Gang Key Card Switch (optical switch)	50/5
	HB828	115/230V Shaver Socket	10/1

Other Products and Accessories

Product	Model No.	Description	Pack (carton/box)
	HB211-M3	400VA 230V 1 Gang Fan Control with off position	60/6
	HB2-ET	630W 230V 1 Gang Touch Dimmer	50/5
	HB2-LTS	100W 230V 1 Gang Touch Dimmer with LED indicator & fire control outlet	100/5





Other Products and Accessories

	Product	Model No.	Description	Pack (carton/box)
4		HB2-LIR	100W 230V 1 Gang IR Motion Detector with fire control outlet	50/5
5		HB2-SC	100W 230V 1 Gang Voice & Light Activated Switch with time delay	50/5
		HB2-SCA	100W 230V 1 Gang Voice & Light Activated Switch with time delay (compatible with CFL)	100/10
		HB2-LSC	100W 230V 1 Gang Voice & Light Activated Switch with time delay & fire control outlet	100/10
6		HB211-M4	2A 230V 1 Gang Electronic Fan Control with speed indicator	50/5
7		HB211-MM4	3A 230V 1 Gang Mechanical Fan Control	50/5
8		HB525	25A 250V Flex Outlet with wiring terminal	50/5
9		HB101	1 Gang Blank Cover Plate	200/20
10		HB101D	2 Gang Blank Cover Plate	200/10
11		HA1103	Cover Plate (square corner) for 86 type socket(vertical mounting)	200/10
12		HA1105	Cover Plate (square corner) for 86 type switch (horizontal mounting)	200/10
13		HA1106	Cover Plate (square corner) for 146 type switch (horizontal mounting)	150/15
14		HA1102	Cover Plate for 86 type switch (horizontal mounting)	200/10
15		HA1103	Cover Plate for 86 type socket (vertical mounting)	200/10
16		HA1104	Cover Plate for 146 type socket (vertical mounting)	150/15

Schematic Wiring Diagrams

3 Gang Switch

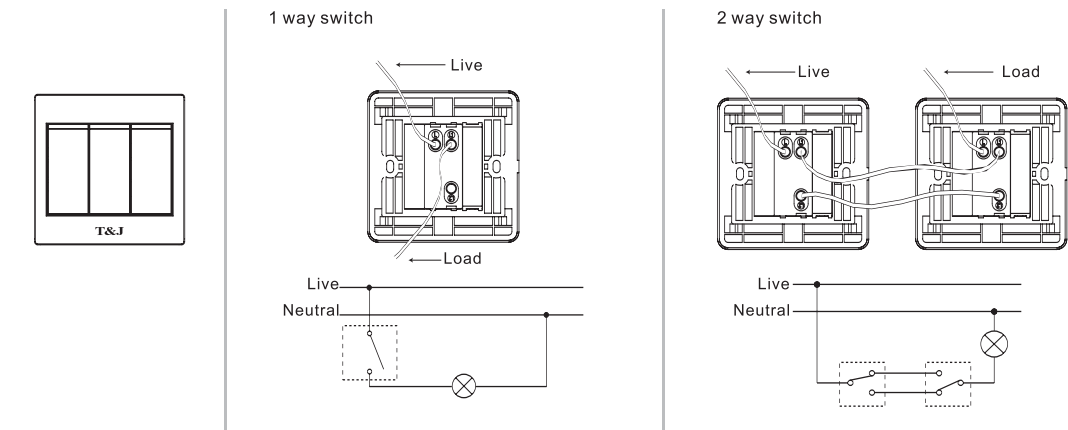

1 Gang Socket

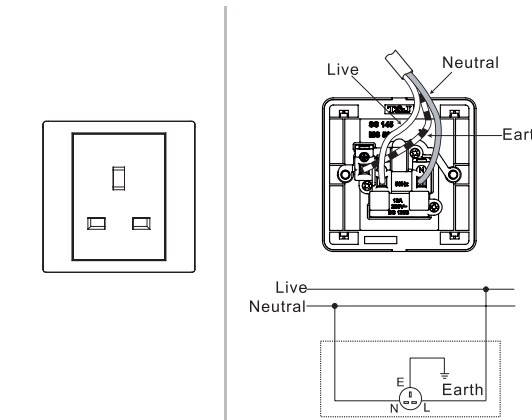

Bell Switch

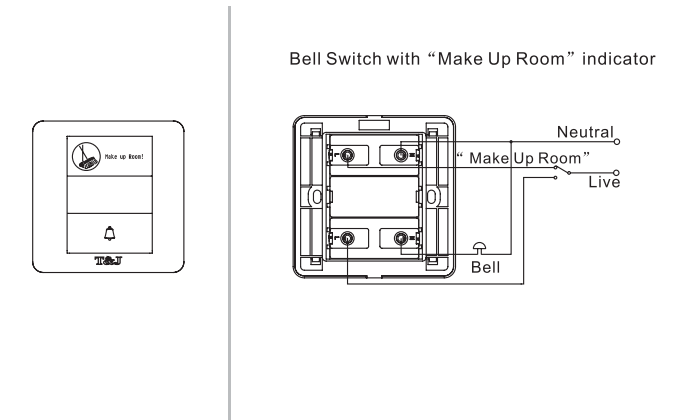

Dimensions

Scale = mm

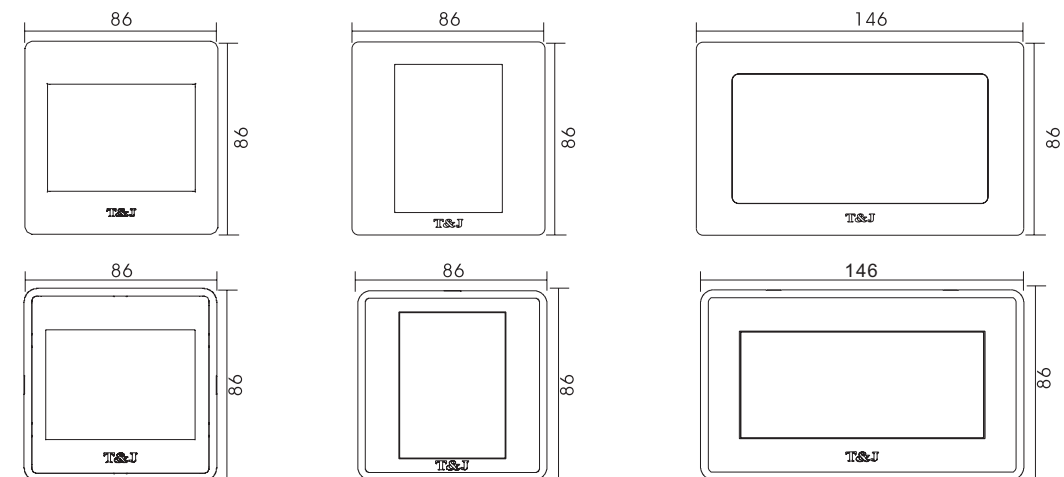

Notes: Chrome-plated frame is available for all the products in this catalogue, please contact our salesman for more details.



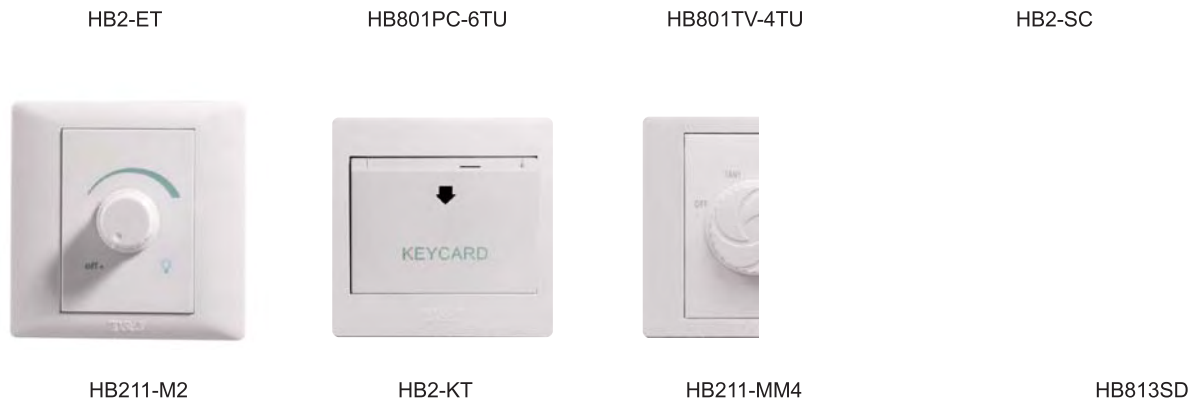

Product Code Rules

Dazzle Coding Rules of HA271-2-N(H)WH(CH)

HB 27 1 - 2 - N(H) WH (CH)

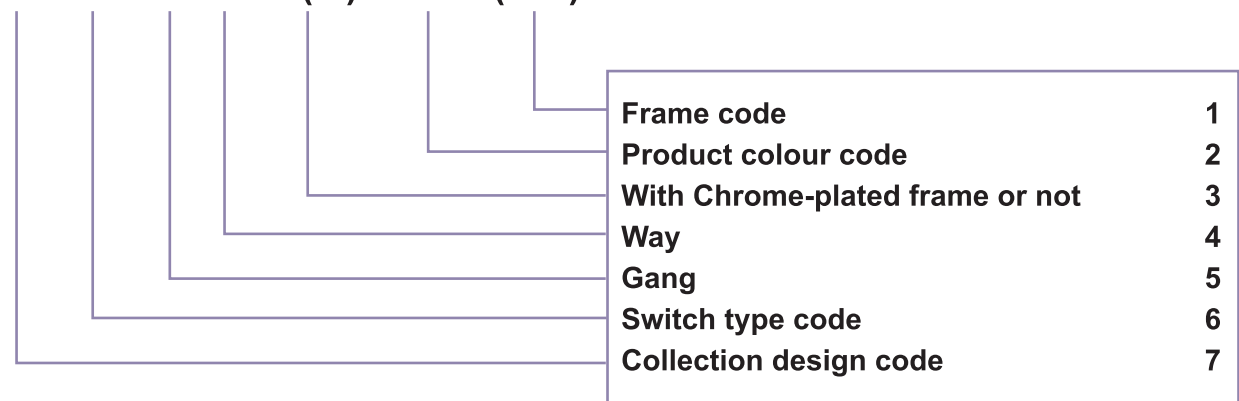

Standard

16A Switch	BS EN60669; IEC 60669
13A BS Sockets	BS 1363
10A GB Sockets	GB 2099
16 A GB Sockets	GB 2099
10A Universal Sockets	IEC 60884

Available Options

1	2	3	4	5	6	7
CH	WH	N	1	1	26	CM B
Chrome-plated	White	Without Chrome-plated Frame	1 Way	1 Gang	Retractive	Colossal Alpine/Exclusif
Blank		H	2	2	27	G H
White		With Chrome-plated Frame	2 Way	2 Gang	Normal Switch	Ultimate Dazzle
				3	21	GC E
				3 Gang	Dimmer Switch	Titanium Unique
				4	810813816	K J
				4 Gang	Socket	Radiance Define/Fusion
				5	801-803	R M
				5 Gang	Telecommunication product	Classy Metaclad
						W P
						Deco Amor
						V HA
						Glare Elegance

Notes:

- *All illustrations and descriptions are only for guidance
- *The colours and product photos you see in this brochure may vary from the actual products
- *All T&J products/colours can be customised to satisfy the unique demand of the widest possible range of end-users
- *T&J Electric reserves the right to change specifications and designs without notice